

東元全密型 **IE4** 超優級效率馬達 (NEMA)

**MODEL : AEHH4E**

HIGH EFFICIENCY MOTORS (IE4)  
LOW VOLTAGE SQUIRREL CAGE  
FRAME SIZE : 143T ~ 405TS



DWG NO.

**31057D98519**

REV. 02

2/2

|   |   | <b>SPECIFICATION TABLE</b>   | MODEL<br><b>AEHH4E</b> |
|---|---|--|------------------------|
|   |   | 3-PHASE INDUCTION MOTORS<br>LOW VOLTAGE SQUIRREL CAGE  |                        |
| ITEM  |   | STANDARD SPECIFICATION   |                        |
| R<br>A<br>T<br>I<br>O<br>N<br>G                     | Kind of Motors  | Squirrel Cage Induction Motors ( SCIM ) .  |                        |
|   | Design Standards  | NEMA MG-1, MG-13, IEC 60034-30.  |                        |
|   | Voltages  | 230/460V ( 208V De-Rating Operation ) .  |                        |
|   | Frequency   | 60Hz .   |                        |
|   | Output Range  | 1HP ~ 100HP .  |                        |
|   | R.P.M. (Syn.)   | 3600, 1800 and 1200 R.P.M. ( 2, 4 and 6 Poles ) .  |                        |
|   | Time Duty   | Continuous, S.F. 1.15 .  |                        |
|   | Frame Size  | 143T ~ 405TS .   |                        |
|   | Protection Enclosure  | Totally Enclosed ( IP44 ) .  |                        |
|   | Cooling Method  | Self External Fan, Surface Cooling ( IC 411 ) .  |                        |
| Mounting  | Horizontal Foot Mounting F-1, F-1 and F-2 Interchangeable . |  |                        |
| A<br>P<br>P<br>L<br>I<br>C<br>A<br>T<br>I<br>O<br>N | Power Condition   | Voltage : $\pm 10\%$ , Frequency : $\pm 5\%$ , and $\pm 10\%$ of Combined Voltage and Frequency, But Frequency Variation Does Not Exceed $\pm 5\%$ .   |                        |
|   | Environment Conditions                                      | Place : Non-Hazardous. Ambient Temperature : $-15^{\circ}\text{C} \sim 40^{\circ}\text{C}$ ,<br>Relative Humidity : Less Than 90%RH ( Non-Condensation ) ,<br>Altitude : Less Than 3,300ft . |                        |
|   | Drive Method  | Belt Service, However for 2 Pole 25HP and Up<br>( TS Frame ) Direct-Coupling Service is the Way.   |                        |
|   | Direction of Rotation                                       | Bi-Directional .   |                        |
|   | Method of Starting  | Full Voltage Direct On Line , For 7.5HP & Up - $\Delta$ Be Available.  |                        |
| P<br>E<br>R<br>F<br>O<br>R<br>M<br>A<br>N<br>C<br>E | Test Procedure  | IEEE-112 Method B and Full Voltage Measuring Starting Performance.   |                        |
|   | Temperature Rise  | Not to Exceed $90^{\circ}\text{C}$ for S.F.1.15 or $80^{\circ}\text{C}$ for S.F.1.0 by Resistance Method.  |                        |
|   | Noise   | Sound Power Not Exceed 90dB ( A ) ( Reference= $10^{-12}\text{W}$ ) .  |                        |
|   | Over Speed  | 125% Syn. R.P.M. for Two Min. ( 2, 4 Poles); 150% Syn. R.P.M. for Two Min. ( the others).  |                        |
|   | Over Torque   | 160% Rated Torque for 15 Sec.  |                        |

|  |  |   |  |  |  |  |  |  |  |  |  |                        |  |
|--|--|---|--|--|--|--|--|--|--|--|--|------------------------|--|
|  |  | <b>PERFORMANCE DATA</b>   |  |  |  |  |  |  |  |  |  | MODEL<br><b>AEHH4E</b> |  |
|  |  | 3-PHASE SQUIRREL CAGE<br>HIGH EFFICIENCY (IE4) INDUCTION MOTORS |  |  |  |  |  |  |  |  |  |                        |  |

TEFC, NEMA T-FRAME, DESIGN - B or C  
CLASS F, 40°C AMBIENT TEMP., CONTINUOUS DUTY  
S.F. 1.15, 460V 60HZ

**TYPICAL PERFORMANCE ( 460 V )**

| OUTPUT |      | FULL<br>LOAD<br>RPM | FRAME<br>NO. | EFFICIENCY          |                    |                    | POWER FACTOR        |                    |                    | CURRENT             |                        | TORQUE                |                         |                    |                       | ROTOR<br>WK <sup>2</sup><br>lb-ft <sup>2</sup> |
|--------|------|---------------------|--------------|---------------------|--------------------|--------------------|---------------------|--------------------|--------------------|---------------------|------------------------|-----------------------|-------------------------|--------------------|-----------------------|--|
| HP     | KW   |                     |              | FULL<br>LOAD<br>(%) | 3/4<br>LOAD<br>(%) | 1/2<br>LOAD<br>(%) | FULL<br>LOAD<br>(%) | 3/4<br>LOAD<br>(%) | 1/2<br>LOAD<br>(%) | FULL<br>LOAD<br>(A) | LOCKED<br>ROTOR<br>(A) | FULL<br>LOAD<br>lb-ft | LOCKED<br>ROTOR<br>%FLT | PULL<br>UP<br>%FLT | BREAK<br>DOWN<br>%FLT |  |
| 1      | 0.75 | 3490                | 143T         | 85.0                | 85.0               | 82.0               | 83.0                | 77.0               | 65.0               | 1.33                | 15                     | 1.504                 | 495                     | 435                | 480                   | 0.045  |
|        |      | 1750                | 143T         | 87.4                | 87.0               | 85.0               | 79.0                | 71.0               | 57.0               | 1.36                | 15                     | 3.000                 | 340                     | 250                | 400                   | 0.103  |
|        |      | 1160                | 145T         | 84.7                | 84.0               | 81.0               | 64.5                | 55.5               | 43.0               | 1.71                | 15                     | 4.526                 | 265                     | 210                | 320                   | 0.136  |
| 1.5    | 1.1  | 3485                | 143T         | 87.0                | 87.5               | 86.0               | 86.5                | 81.0               | 71.0               | 1.87                | 20                     | 2.260                 | 445                     | 390                | 450                   | 0.059  |
|        |      | 1745                | 145T         | 88.3                | 88.0               | 87.0               | 80.5                | 73.0               | 60.0               | 1.98                | 20                     | 4.513                 | 330                     | 240                | 380                   | 0.122  |
|        |      | 1170                | 182T         | 89.2                | 88.0               | 85.0               | 62.0                | 54.0               | 41.5               | 2.54                | 20                     | 6.731                 | 230                     | 230                | 435                   | 0.349  |
| 2      | 1.5  | 3475                | 145T         | 87.5                | 88.0               | 87.0               | 87.0                | 82.0               | 71.5               | 2.46                | 25                     | 3.022                 | 405                     | 355                | 410                   | 0.064  |
|        |      | 1745                | 145T         | 88.5                | 88.0               | 86.0               | 77.0                | 69.0               | 55.0               | 2.75                | 25                     | 6.018                 | 365                     | 265                | 405                   | 0.136  |
|        |      | 1170                | 184T         | 90.1                | 89.0               | 87.0               | 65.0                | 57.0               | 45.0               | 3.20                | 25                     | 8.975                 | 210                     | 210                | 400                   | 0.460  |
| 3      | 2.2  | 3510                | 182T         | 89.5                | 90.0               | 90.0               | 89.5                | 86.5               | 78.5               | 3.51                | 32                     | 4.488                 | 290                     | 275                | 375                   | 0.190  |
|        |      | 1755                | 182T         | 91.0                | 91.0               | 90.0               | 78.5                | 71.5               | 59.0               | 3.93                | 32                     | 8.975                 | 270                     | 240                | 380                   | 0.401  |
|        |      | 1175                | 213T         | 90.9                | 90.0               | 88.0               | 77.5                | 70.5               | 58.0               | 3.99                | 32                     | 13.41                 | 215                     | 185                | 380                   | 0.918  |
| 5      | 3.7  | 3500                | 184T         | 90.5                | 91.5               | 92.0               | 91.0                | 89.0               | 83.0               | 5.68                | 46                     | 7.501                 | 255                     | 240                | 340                   | 0.272  |
|        |      | 1755                | 184T         | 91.0                | 91.0               | 90.0               | 79.5                | 73.0               | 61.0               | 6.47                | 46                     | 14.96                 | 255                     | 225                | 360                   | 0.474  |
|        |      | 1170                | 215T         | 91.0                | 91.0               | 90.0               | 80.0                | 74.0               | 63.0               | 6.43                | 46                     | 22.44                 | 200                     | 160                | 330                   | 1.224  |
| 7.5    | 5.5  | 3525                | 213T         | 91.5                | 92.0               | 91.5               | 86.0                | 83.5               | 76.5               | 8.92                | 64                     | 11.17                 | 195                     | 150                | 270                   | 0.412  |
|        |      | 1765                | 213T         | 92.9                | 92.5               | 92.0               | 82.5                | 78.0               | 68.0               | 9.17                | 64                     | 22.31                 | 235                     | 190                | 310                   | 0.924  |
|        |      | 1175                | 254T         | 92.2                | 91.5               | 91.0               | 79.0                | 74.0               | 64.0               | 9.64                | 64                     | 33.51                 | 285                     | 240                | 275                   | 2.657  |
| 10     | 7.5  | 3520                | 215T         | 92.0                | 93.0               | 92.5               | 86.5                | 84.0               | 78.0               | 11.8                | 81                     | 14.92                 | 200                     | 150                | 260                   | 0.512  |
|        |      | 1765                | 215T         | 92.9                | 93.0               | 92.5               | 84.0                | 80.5               | 71.5               | 12.0                | 81                     | 29.75                 | 230                     | 190                | 290                   | 1.082  |
|        |      | 1175                | 256T         | 92.5                | 92.0               | 91.5               | 80.5                | 75.5               | 65.5               | 12.6                | 81                     | 44.69                 | 280                     | 240                | 270                   | 3.487  |
| 15     | 11   | 3545                | 254T         | 92.6                | 93.0               | 92.5               | 91.0                | 89.0               | 84.0               | 16.7                | 116                    | 22.22                 | 200                     | 150                | 275                   | 1.141  |
|        |      | 1770                | 254T         | 93.6                | 94.0               | 93.5               | 86.5                | 84.5               | 76.5               | 17.3                | 116                    | 44.50                 | 210                     | 160                | 250                   | 2.349  |
|        |      | 1175                | 284T         | 93.0                | 93.0               | 92.5               | 82.0                | 78.5               | 69.0               | 18.4                | 116                    | 67.03                 | 250                     | 200                | 250                   | 6.824  |
| 20     | 15   | 3535                | 256T         | 92.4                | 93.0               | 93.0               | 91.0                | 90.0               | 86.0               | 22.3                | 145                    | 29.71                 | 200                     | 150                | 240                   | 1.407  |
|        |      | 1770                | 256T         | 94.1                | 94.5               | 94.0               | 87.0                | 85.0               | 77.5               | 22.9                | 145                    | 59.33                 | 205                     | 160                | 240                   | 3.002  |
|        |      | 1175                | 286T         | 93.0                | 93.0               | 93.0               | 83.0                | 79.0               | 70.0               | 24.3                | 145                    | 89.37                 | 245                     | 195                | 240                   | 8.340  |
| 25     | 18.5 | 3535                | 284TS        | 93.0                | 93.5               | 93.0               | 92.0                | 92.5               | 88.5               | 27.4                | 183                    | 37.13                 | 200                     | 150                | 240                   | 1.735  |
|        |      | 1775                | 284T         | 94.5                | 94.0               | 94.0               | 86.0                | 81.5               | 77.0               | 28.8                | 183                    | 73.95                 | 215                     | 165                | 245                   | 4.586  |
|        |      | 1185                | 324T         | 94.2                | 94.0               | 93.5               | 86.0                | 83.5               | 76.0               | 28.9                | 183                    | 110.8                 | 220                     | 175                | 240                   | 17.246   |
| 30     | 22   | 3535                | 286TS        | 93.0                | 94.0               | 93.5               | 92.0                | 93.0               | 89.0               | 32.8                | 218                    | 44.56                 | 200                     | 150                | 230                   | 1.959  |
|        |      | 1775                | 286T         | 94.5                | 94.5               | 94.5               | 86.5                | 82.0               | 79.0               | 34.4                | 218                    | 88.74                 | 205                     | 160                | 230                   | 5.503  |
|        |      | 1185                | 326T         | 94.5                | 94.5               | 94.0               | 86.0                | 83.5               | 76.0               | 34.6                | 218                    | 132.9                 | 230                     | 180                | 245                   | 18.626   |
| 40     | 30   | 3560                | 324TS        | 94.1                | 94.0               | 93.5               | 92.0                | 92.0               | 89.0               | 43.3                | 290                    | 58.99                 | 140                     | 125                | 250                   | 6.373  |
|        |      | 1780                | 324T         | 95.1                | 95.5               | 95.0               | 87.0                | 84.0               | 77.5               | 45.3                | 290                    | 118.0                 | 205                     | 180                | 260                   | 10.272   |
|        |      | 1185                | 364T         | 95.0                | 95.0               | 95.0               | 85.0                | 83.5               | 76.5               | 46.4                | 290                    | 177.2                 | 215                     | 185                | 240                   | 27.044   |
| 50     | 37   | 3560                | 326TS        | 94.5                | 94.5               | 94.0               | 92.0                | 92.0               | 89.0               | 53.8                | 363                    | 73.74                 | 140                     | 125                | 250                   | 7.044  |
|        |      | 1780                | 326T         | 95.4                | 96.0               | 95.0               | 87.0                | 84.5               | 78.0               | 56.4                | 363                    | 147.5                 | 205                     | 180                | 250                   | 11.739   |
|        |      | 1185                | 365T         | 95.1                | 95.0               | 95.0               | 85.5                | 84.0               | 76.5               | 57.6                | 363                    | 221.5                 | 220                     | 190                | 240                   | 31.371   |
| 60     | 45   | 3565                | 364TS        | 94.7                | 95.0               | 94.0               | 91.0                | 90.5               | 87.0               | 65.2                | 435                    | 88.37                 | 135                     | 120                | 245                   | 7.980  |
|        |      | 1780                | 364T         | 95.7                | 95.5               | 95.0               | 89.0                | 87.0               | 81.0               | 66.0                | 435                    | 177.0                 | 200                     | 185                | 255                   | 21.481   |
|        |      | 1185                | 404T         | 95.4                | 95.5               | 95.0               | 85.0                | 82.0               | 74.0               | 69.3                | 435                    | 265.8                 | 175                     | 160                | 250                   | 41.367   |
| 75     | 55   | 3570                | 365TS        | 95.0                | 95.0               | 95.0               | 91.0                | 90.5               | 87.0               | 81.2                | 543                    | 110.3                 | 155                     | 135                | 260                   | 9.178  |
|        |      | 1780                | 365T         | 96.1                | 96.0               | 95.0               | 89.5                | 87.5               | 82.0               | 81.6                | 543                    | 221.2                 | 200                     | 185                | 245                   | 25.778   |
|        |      | 1185                | 405T         | 95.6                | 95.5               | 95.0               | 85.0                | 82.0               | 73.5               | 86.4                | 543                    | 332.3                 | 175                     | 160                | 250                   | 45.647   |
| 100    | 75   | 3570                | 405TS        | 95.5                | 96.0               | 95.5               | 90.5                | 90.0               | 86.0               | 108                 | 725                    | 147.1                 | 135                     | 120                | 285                   | 14.091   |
|        |      | 1780                | 405T         | 96.2                | 96.0               | 95.0               | 88.0                | 85.5               | 79.0               | 111                 | 725                    | 295.0                 | 160                     | 150                | 260                   | 34.124   |

- NOTE :
- The above are typical values based on test according to ANSI/IEEE standard 112 method B.
  - Breakdown & locked rotor torques are shown as average expected values.
  - Efficiency, power factor, speed and torque are the same for other voltages.  
Current values vary inversely with voltage.
  - Efficiency according to IEC 60034-30.
  - Tolerance according to NEMA MG1-12 & IEC 60034-1.
  - Data subject to change without notice.

# OUTLINE DIMENSIONS SHEET

MODEL

**AEHH4E**

3-PHASE INDUCTION MOTORS  
FRAME SIZE 143T ~ 215T

Totally Enclosed Fan - Cooled Type, Squirrel - Cage Rotor.

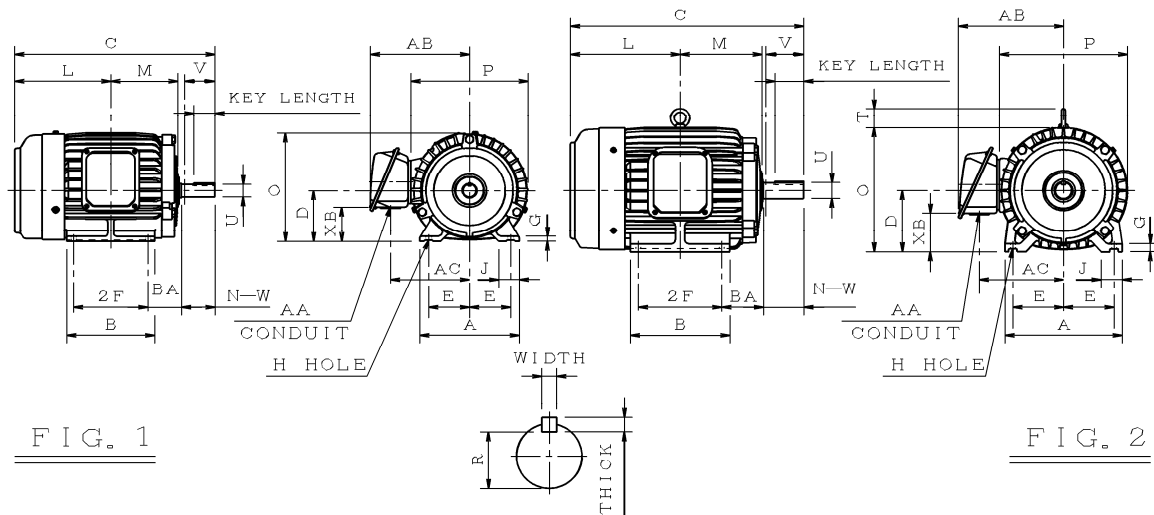

Dimension in inches

| Output (HP) |          |     | FRAME SIZE | FIG. NO. | Mounting |      |      |      | A    | B    | C     | D    | G    | J    | L    | M    | O     | P     |
|-------------|----------|-----|------------|----------|----------|------|------|------|------|------|-------|------|------|------|------|------|-------|-------|
| 2P          | 4P       | 6P  |            |          | E        | 2F   | H    | BA   |      |      |       |      |      |      |      |      |       |       |
| 1.5         | 1        | —   | 143T       | 1        | 2.75     | 4.00 | 0.34 | 2.25 | 6.70 | 5.10 | 12.47 | 3.50 | 0.35 | 1.40 | 5.96 | 4.00 | 7.45  | 7.87  |
| 2           | 1.5<br>2 | 1   | 145T       |          | 2.75     | 5.00 | 0.34 | 2.25 | 6.70 | 5.90 | 13.46 | 3.50 | 0.35 | 1.40 | 6.46 | 4.50 | 7.45  | 7.87  |
| 3           | 3        | 1.5 | 182T       | 2        | 3.75     | 4.50 | 0.41 | 2.75 | 8.80 | 5.90 | 14.77 | 4.50 | 0.65 | 1.75 | 7.03 | 4.85 | 9.15  | 9.37  |
| 5           | 5        | 2   | 184T       |          | 3.75     | 5.50 | 0.41 | 2.75 | 8.80 | 6.90 | 15.79 | 4.50 | 0.65 | 1.75 | 7.54 | 5.35 | 9.15  | 9.37  |
| 7.5         | 7.5      | 3   | 213T       |          | 4.25     | 5.50 | 0.41 | 3.50 | 9.85 | 6.90 | 18.09 | 5.25 | 0.70 | 1.75 | 8.46 | 6.05 | 10.60 | 10.75 |
| 10          | 10       | 5   | 215T       |          | 4.25     | 7.00 | 0.41 | 3.50 | 9.85 | 8.35 | 19.59 | 5.25 | 0.70 | 1.75 | 9.21 | 6.80 | 10.60 | 10.75 |

| FRAME SIZE | T    | Key   |       |        | Keyseat R | Shaft Extension |       |       | Terminal Housing |      |      |      | Bearings  |                    | APPROX. WEIGHT LBS |
|------------|------|-------|-------|--------|-----------|-----------------|-------|-------|------------------|------|------|------|-----------|--------------------|--------------------|
|            |      | WIDTH | THICK | LENGTH |           | N-W             | U     | V     | AA               | AB   | AC   | XB   | DRIVE END | OPPOSITE DRIVE END |                    |
| 143T       | —    | 0.188 | 0.188 | 1.410  | 0.771     | 2.250           | 0.875 | 2.200 | 1.10             | 6.18 | 4.92 | 2.52 | 6205ZZ    | 6205ZZ             | 44                 |
| 145T       | —    | 0.188 | 0.188 | 1.410  | 0.771     | 2.250           | 0.875 | 2.200 | 1.10             | 6.18 | 4.92 | 2.52 | 6205ZZ    | 6205ZZ             | 53                 |
| 182T       | 1.30 | 0.250 | 0.250 | 1.780  | 0.986     | 2.750           | 1.125 | 2.700 | 1.10             | 7.44 | 6.06 | 3.36 | 6306ZZ    | 6306ZZ             | 81                 |
| 184T       | 1.30 | 0.250 | 0.250 | 1.780  | 0.986     | 2.750           | 1.125 | 2.700 | 1.10             | 7.44 | 6.06 | 3.36 | 6306ZZ    | 6306ZZ             | 95                 |
| 213T       | 1.65 | 0.312 | 0.312 | 2.410  | 1.201     | 3.380           | 1.375 | 3.300 | 1.38             | 8.86 | 7.07 | 3.32 | 6308ZZ    | 6306ZZ             | 150                |
| 215T       | 1.65 | 0.312 | 0.312 | 2.410  | 1.201     | 3.380           | 1.375 | 3.300 | 1.38             | 8.86 | 7.07 | 3.32 | 6308ZZ    | 6306ZZ             | 176                |

- Note :**
1. Dimension D tolerance : +0.00 inches, -0.03 inches.
  2. Dimension U tolerance : +0.000 inches, -0.0005 inches.
  3. Dimension R tolerance : +0.000 inches, -0.015 inches.
  4. Dimension V is length of straight part of shaft.

# OUTLINE DIMENSIONS SHEET

MODEL

**AEHH4E**

3-PHASE INDUCTION MOTORS  
FRAME SIZE 254T ~ 286TS

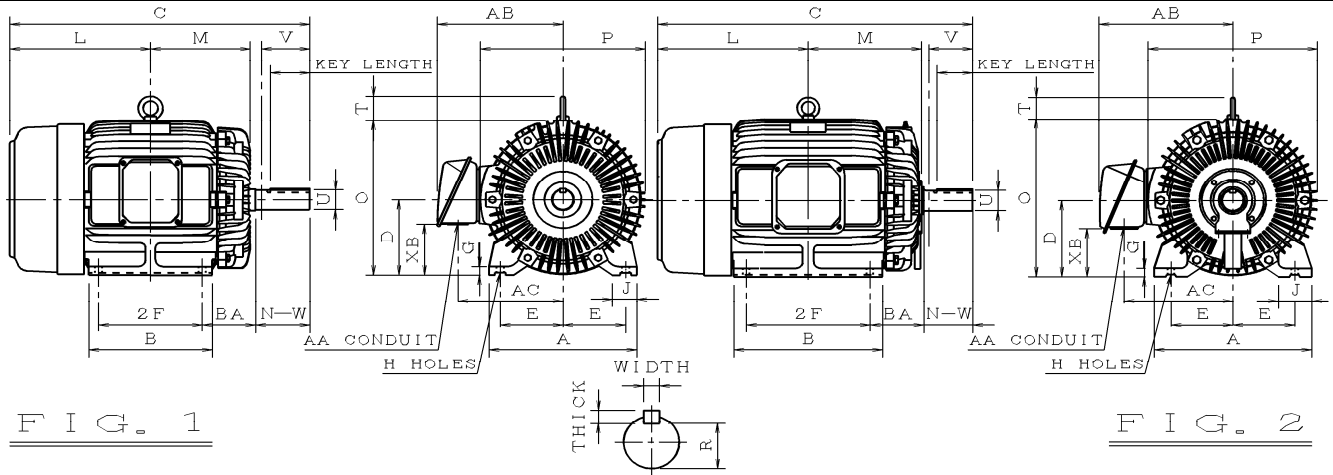

FIG. 1

FIG. 2

Dimension in inches

| Output (HP) |     |     | FRAME SIZE | FIG. NO. | Mounting |       |      |       | A     | B     | C     | D     | G    | J     | L     | M     | O     | P     |
|-------------|-----|-----|------------|----------|----------|-------|------|-------|-------|-------|-------|-------|------|-------|-------|-------|-------|-------|
| 2P          | 4P  | 6P  |            |          | E        | 2F    | H    | BA    |       |       |       |       |      |       |       |       |       |       |
| 15          | 15  | 7.5 | 254T       | 3        | 5.00     | 8.25  | 0.53 | 4.25  | 11.80 | 9.85  | 23.60 | 6.25  | 0.65 | 1.95  | 11.23 | 7.98  | 12.80 | 13.15 |
| 20          | 20  | 10  | 256T       |          | 5.00     | 10.00 | 0.53 | 4.25  | 11.80 | 11.80 | 25.34 | 6.25  | 0.65 | 1.95  | 12.09 | 8.86  | 12.80 | 13.15 |
| —           | 25  | 15  | 284T       |          | 5.50     | 9.50  | 0.53 | 4.75  | 14.00 | 11.70 | 26.74 | 7.00  | 0.79 | 2.95  | 12.62 | 9.11  | 14.50 | 15.05 |
| 25          | —   | —   | 284TS      | 4        | 5.50     | 9.50  | 0.53 | 4.75  | 14.00 | 11.70 | 25.37 | 7.00  | 0.79 | 2.95  | 12.62 | 9.31  | 14.50 | 15.05 |
| —           | 30  | 20  | 286T       | 3        | 5.50     | 11.00 | 0.53 | 4.75  | 14.00 | 13.20 | 28.24 | 7.00  | 0.79 | 2.95  | 13.37 | 9.86  | 14.50 | 15.05 |
| 30          | —   | —   | 286TS      | 4        | 5.50     | 11.00 | 0.53 | 4.75  | 14.00 | 13.20 | 26.87 | 7.00  | 0.79 | 2.95  | 13.37 | 10.06 | 14.50 | 15.05 |
| -           | 40  | 25  | 324T       |          | 6.25     | 10.50 | 0.67 | 5.25  | 15.75 | 14.37 | 31.25 | 8.00  | 1.11 | 3.15  | 14.75 | 11.04 | 17.02 | 18.03 |
| 40          | -   | -   | 324TS      |          | 6.25     | 10.50 | 0.67 | 5.25  | 15.75 | 14.37 | 29.75 | 8.00  | 1.11 | 3.15  | 14.75 | 11.04 | 17.02 | 18.03 |
| -           | 50  | 30  | 326T       |          | 6.25     | 12.00 | 0.67 | 5.25  | 15.75 | 15.75 | 32.62 | 8.00  | 1.11 | 3.15  | 15.43 | 11.73 | 17.02 | 18.03 |
| 50          | -   | -   | 326TS      |          | 6.25     | 12.00 | 0.67 | 5.25  | 15.75 | 15.75 | 31.12 | 8.00  | 1.11 | 3.15  | 15.43 | 11.73 | 17.02 | 18.03 |
| -           | 60  | 40  | 364T       |          | 7.00     | 11.25 | 0.67 | 5.88  | 17.70 | 16.34 | 35.03 | 9.00  | 1.32 | 3.55  | 16.39 | 12.56 | 19.04 | 20.08 |
| 60          | -   | -   | 364TS      |          | 7.00     | 11.25 | 0.67 | 5.88  | 17.70 | 16.34 | 32.91 | 9.00  | 1.32 | 3.55  | 16.39 | 12.56 | 19.04 | 20.08 |
| -           | 75  | 50  | 365T       |          | 7.00     | 12.25 | 0.67 | 5.88  | 17.70 | 16.34 | 35.03 | 9.00  | 1.32 | 3.55  | 16.39 | 12.56 | 19.04 | 20.08 |
| 75          | -   | -   | 365TS      |          | 7.00     | 12.25 | 0.67 | 5.88  | 17.70 | 16.34 | 32.91 | 9.00  | 1.32 | 3.55  | 16.39 | 12.56 | 19.04 | 20.08 |
| -           | —   | 60  | 404T       |          | 8.00     | 12.25 | 0.81 | 6.62  | 19.68 | 15.16 | 36.50 | 10.00 | 1.42 | 3.93  | 16.50 | 12.52 | 20.71 | 21.46 |
| —           | 100 | 75  | 405T       | 8.00     | 13.75    | 0.81  | 6.62 | 19.68 | 18.90 | 40.23 | 10.00 | 1.42  | 3.93 | 18.36 | 14.39 | 20.71 | 21.46 |       |
| 100         | —   | —   | 405TS      | 8.00     | 13.75    | 0.81  | 6.62 | 19.68 | 18.90 | 37.23 | 10.00 | 1.42  | 3.93 | 18.36 | 14.39 | 20.71 | 21.46 |       |

| FRAME SIZE | T    | Key   |       |        | Keyseat R | Shaft Extension |       |       | Terminal Housing |       |       |      | Bearings  |                    | APPROX. WEIGHT LBS |
|------------|------|-------|-------|--------|-----------|-----------------|-------|-------|------------------|-------|-------|------|-----------|--------------------|--------------------|
|            |      | WIDTH | THICK | LENGTH |           | N-W             | U     | V     | AA               | AB    | AC    | XB   | DRIVE END | OPPOSITE DRIVE END |                    |
| 254T       | 2.01 | 0.375 | 0.375 | 2.910  | 1.416     | 4.000           | 1.625 | 3.900 | 1.38             | 10.24 | 8.58  | 4.37 | 6309ZZ    | 6307ZZ             | 267                |
| 256T       | 2.01 | 0.375 | 0.375 | 2.910  | 1.416     | 4.000           | 1.625 | 3.900 | 1.38             | 10.24 | 8.58  | 4.37 | 6309ZZ    | 6307ZZ             | 311                |
| 284T       | 2.36 | 0.500 | 0.500 | 3.280  | 1.591     | 4.620           | 1.875 | 4.500 | 2.05             | 12.13 | 9.84  | 4.59 | 6311ZZ    | 6310ZZ             | 399                |
| 284TS      | 2.36 | 0.375 | 0.375 | 1.930  | 1.416     | 3.250           | 1.625 | 3.200 | 2.05             | 12.13 | 9.84  | 4.59 | 6211C3    | 6211C3             | 381                |
| 286T       | 2.36 | 0.500 | 0.500 | 3.280  | 1.591     | 4.620           | 1.875 | 4.500 | 2.05             | 12.13 | 9.84  | 4.59 | 6311ZZ    | 6310ZZ             | 454                |
| 286TS      | 2.36 | 0.375 | 0.375 | 1.930  | 1.416     | 3.250           | 1.625 | 3.200 | 2.05             | 12.13 | 9.84  | 4.59 | 6211C3    | 6211C3             | 430                |
| 324T       | 2.76 | 0.500 | 0.500 | 3.910  | 1.845     | 5.250           | 2.125 | 5.150 | 2.56             | 14.25 | 11.77 | 5.19 | 6312      | 6212               | 728                |
| 324TS      | 2.76 | 0.500 | 0.500 | 2.030  | 1.591     | 3.750           | 1.875 | 3.650 | 2.56             | 14.25 | 11.77 | 5.19 | 6312C3    | 6212C3             | 706                |
| 326T       | 2.76 | 0.500 | 0.500 | 3.910  | 1.845     | 5.250           | 2.125 | 5.150 | 2.56             | 14.25 | 11.77 | 5.19 | 6312      | 6212               | 849                |
| 326TS      | 2.76 | 0.500 | 0.500 | 2.030  | 1.591     | 3.750           | 1.875 | 3.650 | 2.56             | 14.25 | 11.77 | 5.19 | 6312C3    | 6212C3             | 783                |
| 364T       | 2.76 | 0.625 | 0.625 | 4.280  | 2.021     | 5.880           | 2.375 | 5.750 | 3.62             | 16.18 | 13.27 | 6.18 | 6313      | 6213               | 1102               |
| 364TS      | 2.76 | 0.500 | 0.500 | 2.030  | 1.591     | 3.750           | 1.875 | 3.650 | 3.62             | 16.18 | 13.27 | 6.18 | 6312C3    | 6212C3             | 1036               |
| 365T       | 2.76 | 0.625 | 0.625 | 4.280  | 2.021     | 5.880           | 2.375 | 5.750 | 3.62             | 16.18 | 13.27 | 6.18 | 6313      | 6213               | 1175               |
| 365TS      | 2.76 | 0.500 | 0.500 | 2.030  | 1.591     | 3.750           | 1.875 | 3.650 | 3.62             | 16.18 | 13.27 | 6.18 | 6312C3    | 6212C3             | 1098               |
| 404T       | 3.54 | 0.750 | 0.750 | 5.650  | 2.450     | 7.250           | 2.875 | 7.150 | 3.62             | 19.65 | 15.12 | 5.63 | 6317      | 6313               | 1235               |
| 405T       | 3.54 | 0.750 | 0.750 | 5.650  | 2.450     | 7.250           | 2.875 | 7.150 | 3.62             | 19.65 | 15.12 | 5.63 | 6317      | 6313               | 1300               |
| 405TS      | 3.54 | 0.500 | 0.500 | 2.780  | 1.845     | 4.250           | 2.125 | 4.150 | 3.62             | 19.65 | 15.12 | 5.63 | 6313C3    | 6313C3             | 1410               |

- Note :**
1. Dimension D tolerance : +0.00 inches, -0.03 inches.
  2. Dimension U tolerance : +0.000 inches, -0.001 inches.
  3. Dimension R tolerance : +0.000 inches, -0.015 inches.
  4. Dimension V is length of straight part of shaft.